

HANDHELD BRANCHPIPE



PRODUCT DESCRIPTION

NAFFCO hand-held branch pipe is made by combination of Aluminum and plastics. The water flow control is by means of SHUT, JET and SPRAY. The branch pipe has male instantaneous coupling inlet.

FEATURES

- BSI Kitemark Certified.
- Handheld Branchpipes are manufactured in compliance with BS EN 15182-1:2007 & BS EN 15182-3:2007+ A1:2009
- Body and Tip made of Aluminum.
- Pipe material made of Polyamide.

SPECIFICATIONS

| | |
|---------------------------|--|
| Model | NF-FB320 |
| Type | Handheld Controllable |
| Flow Control | Shut, Jet & Spray |
| Type of Spray | Full Cone |
| Inlet Connection | Male instantaneous coupling to BS 336 |
| Working Pressure | 16 bar |
| Hydrostatic Test Pressure | 25.5 bar |
| Flow Rate | 240 LPM @ 6 bar(Jet) 230 LPM @ 6 bar(Spray) |
| Length | 445 mm |

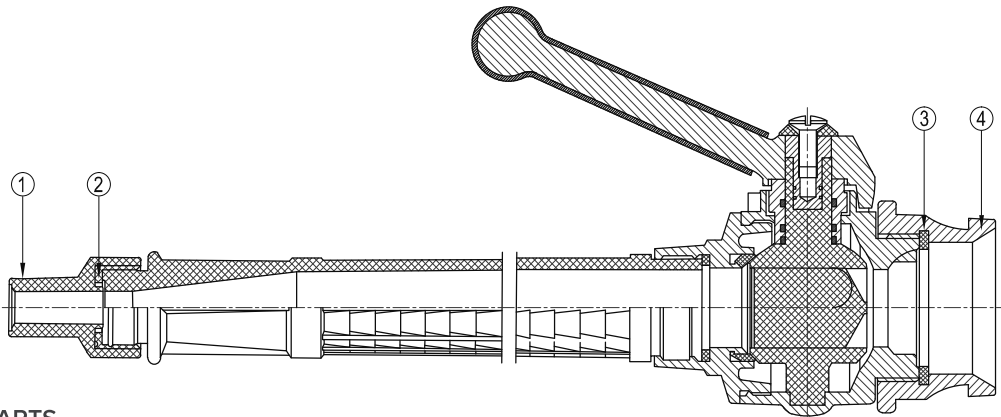

PARTS

1. Nozzle

2. Nozzle Washer

3. Inlet Coupling Washer

4. Inlet Coupling

APPLICATIONS

- Industrial and rural fire brigades as well as building protection.
- For general industrial, commercial and civil engineering applications.
- Ideal for Fire Departments and Professional Industry services.
- Refineries, Armed Forces, Airports, Ships, Oil Rigs, Heavy Industry

MAINTENANCE INSTRUCTIONS

- Keep it in cover.
- After use drain the water and disconnect from hose.
- Every 6 months verify the lever operating & Jet/Spray