

OBLIQUE VALVE, MALE THREADED INLET
MODEL: NDR 097



NOTES :-

1. ALL DIMENSIONS ARE IN mm. UNLESS OTHERWISE SPECIFIED
2. MAX. WORKING PRESSURE: 15BAR
3. TEST PRESSURE
 - a. VALVE SEAT TEST AT 16.5 BAR FOR.
 - b. BODY TEST AT 22.5 BAR.
4. LANDING VALVE CONFORMING TO BS 5041: PART 1
5. MIN. WATER FLOW RATE AND OUTLET PRESSURE :8.5 L/S @ 4.7 BAR

BILL OF MATERIALS

ITEM NO.	DESCRIPTION	MATERIAL/GRADE
1	HAND WEEL	GREY CAST IRON
2	STEM	COPPER ALLOY, CW721R
3	BONNET	COPPER ALLOY, CZ122
4	BODY	COPPER ALLOY, CC491K
5	FEMALE INST. OUTLET	COPPER ALLOY, CC491K
6	CAM TOOTH	COPPER ALLOY, CC491K
7	BLANK CAP	COPPER ALLOY, CC491K
8	RENEWABLE DISK FACING	RUBBER, CHLOROPENE Z70
9	RENEWABLE DISK	COPPER-ZINC ALLOY, CC491K
10	WASHER	RUBBER, CHLOROPENE Z70
11	UPPER PART OF LUG	COPPER ALLOY, CC491K
12	LOWER PART OF LUG	COPPER ALLOY, CC491K
13	GLAND RUBBER SEAL	-
14	BONNER TEFLON SEAL	-
15	WASHER (OD45X13X2.5thick.)	COPPER ALLOY, CC491K
16	NUT	COPPER ALLOY, CC491K
17	GLAND NUT	COPPER ALLOY, CC491K
18	NUT	FORGED STEEL, GALVANIZED
19	WASHER (OD24X13X1.5thick.)	STAINLESS STEEL 304
20	'S' HOOK & CHAIN	'S' - HOOK : BRASS CHAIN : STAINLESS STEEL
21	STRAP WITH PAD LOCK	STRAP-LATHER (12mm WIDE, 400 mm LONG, 2mm THICK) LOCK - NON-FERROUS

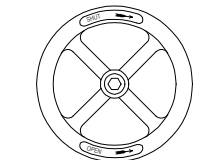

HAND WHEEL MARKING

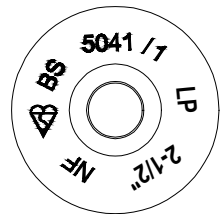

**VIEW-B
(BODY MARKING)**

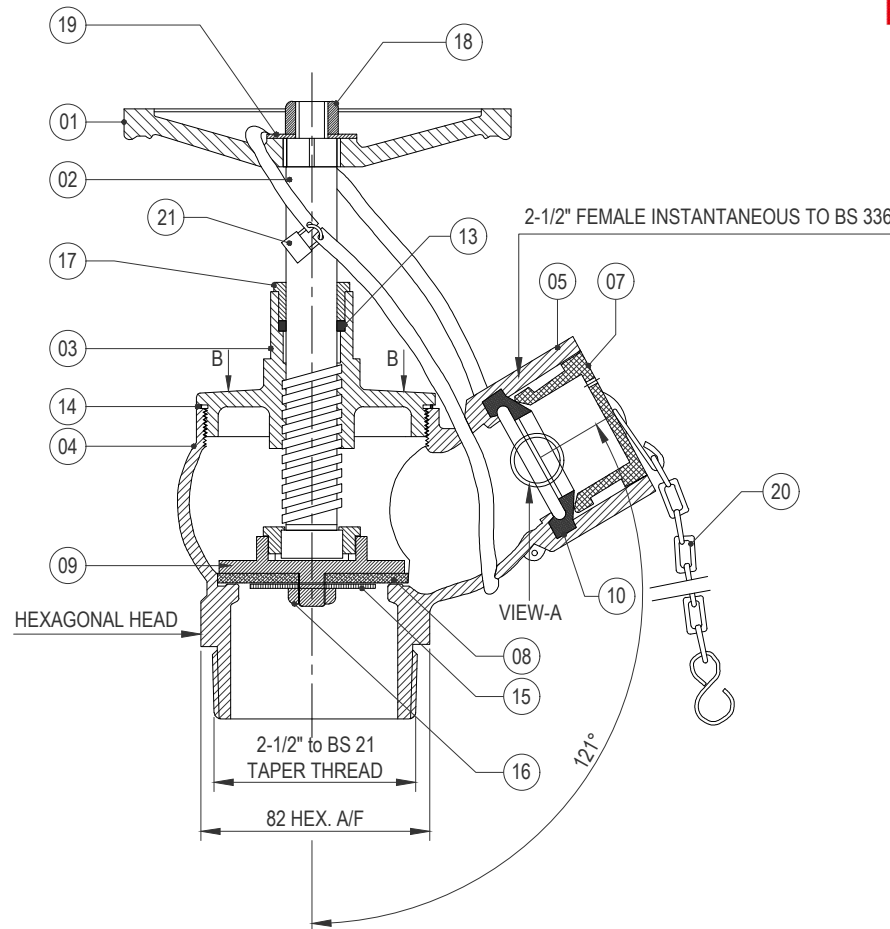

3 mm PRESSURE RELIEF HOLE

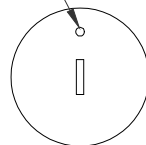

BLANK CAP TOP VIEW

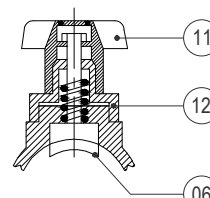

REAR VIEW-A

SPECIFICATION:-

MODEL	NDR 097
VALVE TYPE	OBLIQUE, THREADED INLET
PRESSURE RATING	LOW PRESSURE VALVE
NOMINAL SIZE	DN 2 1/2"
WORKING PRESSURE	15 BAR MAXIMUM
TEST PRESSURE	VALVE SEAT TEST AT 16.5 BAR, BODY TEST AT 22.5 BAR
WATER FLOW RATE	8.5 L/S @ 4 BAR OUTLET PRESSURE