

Glazed Curtain Wall



**FIRE
INTEGRITY
UP TO
120min.**

This system for thermally insulated curtain walls is based on a mullion/transom construction. Very narrow facing widths from 45 mm permit a wide range of applications such as fire protection and burglary resistance. Production and assembly is now even more efficient. Clever processing tools save your time and enhance the work piece accuracy with pre-marked weather-stripping. The system has been comprehensively tested to both the European and North American Standards for fire resistance. Certified for fire EI (Integrity and Insulation) classification up to 120 minutes of fire resistance, and for EW (Integrity & Radiation Control) and E (Integrity) fire classifications.

Features and Benefits

- Fire protection
- Smoke protection
- Burglary-resistance
- Bullet resistance
- Thermal break
- Explosion inhibition
- Minimal face widths
- Without thermal break
- Great acoustic performance
- Interior & exterior use
- Multiple finishes.
- Largest glass area tested and certified

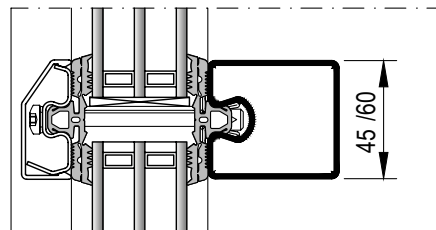
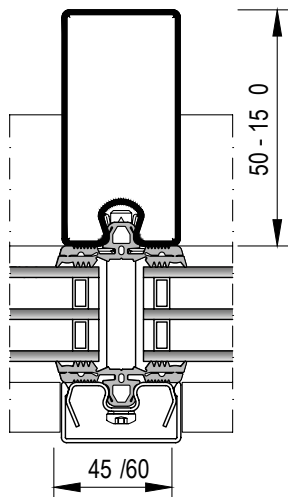
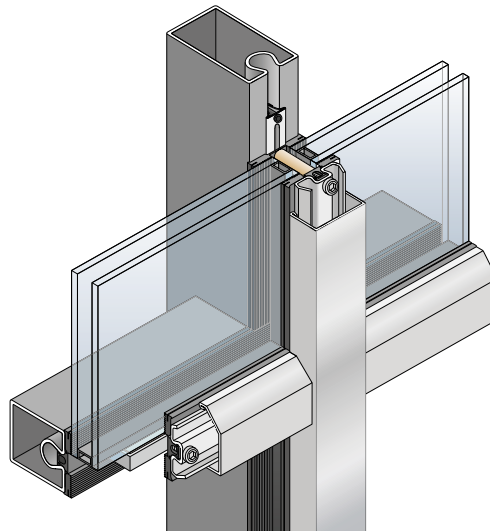

Technical Data

	Description	Result	Standard
Material options	Black box steel (mild steel) profiles		
	Galvanized steel profiles		
	Available profile widths: 45mm and 60mm		
	Stainless steel grade 304 available for some sections (brush finish grain 220-240)		
	Aluminium and stainless steel capping with stainless steel pressure plates		
Fire resistant options	Fixed partitions	EW30 to EW120 EI30 to EI90	EN 1364-1
	Facades	EW30 to EW120 and EI60	EN 1634-1
	Fixed partitions	1 and 2 hours temperature rise restricted (T)	UL263/NFPA 251
Fire code compliance	European and North American Standards		
	NFPA 101 and NFPA 80		
	GCC Civil Defence Approved through local forster fabricators		
Tested design variants*	Tested with single, double and tripple glazed options		
	Classification from CE-tests according to EN 13830:		
	1. Thermal insulation: U-Values	Up to 1.0 W/(m ² K)	
	2. Resistance to wind load	3kN, safety load 4.5 kN	EN 12179
	3. Water Penetration	RE 1200	EN 12155
	4. Air permeability	AE (>600)	EN 12153
	5. Sound insulation	Rw up to 45 dB	EN ISO 140-3
	6. Impact resistance	E5/I5	EN 14019
	7. Burglary resistance	RC 2-3	EN 1627-1630
	8. Ballistic rating	FB4, FB6 and FB7	EN 1522
9. Blast resistant facade	EPR1 (S)	EN 13123-1	
System properties	Extremely slender visible section widths (45mm and 60mm) and depth		
	Can be powder coated or wet paint coated (to be checked with local applicator)		
	Large glass panels available for fire rated systems		
	Extremely economical manufacturing without special equipment		
	Robust system, resistant to damage		

*Refer to country-specific approvals