

PORTABLE MONITOR

MODEL: NF-20A

DESCRIPTION

Portable Monitor is used in the place where operator is difficult to access like hazardous storage, outdoor oil tank, gas storage tank, chemical factory. Also equipped in the fire truck to deploy during fire fighting operation at the hard to access area. Monitor is light weight for easy transportation to required area. Foldable type legs can be folded by one simple touch for quick transportation.

Vertical movement is 90° (85° above and 5° below horizontal) and horizontal movement is a full, continuous 360° (hand wheel remains stationary), grease-zerk for easy lubrication.

APPLICATION

For total flooding applications, on the outdoor hydrant, fire trucks, mines, tunnels and etc.



TECHNICAL DATA

Inlet	2½" NH female swivel
Outlet	2½" NH male
Material	Aluminum alloy (ASTM 355)
Monitor Elevation	135° vertical movement Vertical movement controlled by lever
Monitor Rotation	Horizontal movement 360° with positive twist locking mechanism
Net weight	15 kg approx.

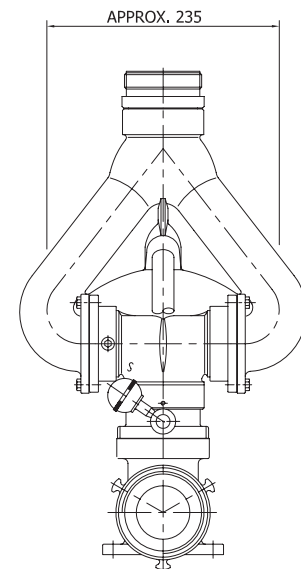
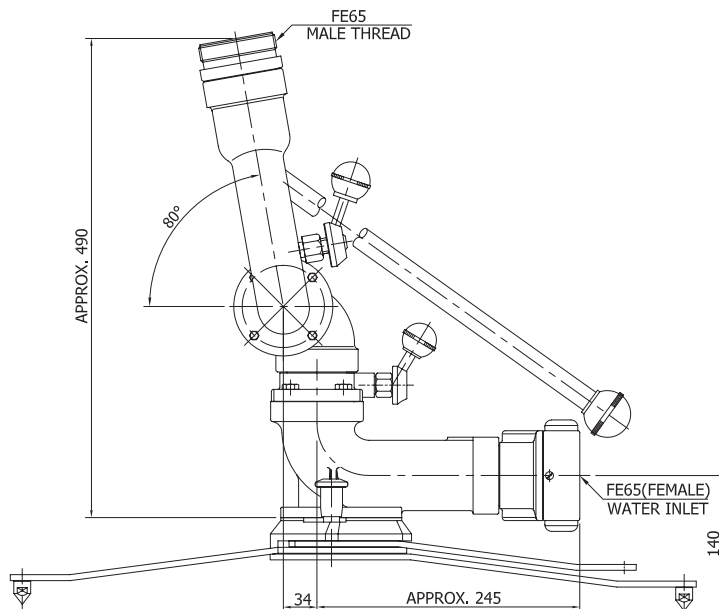
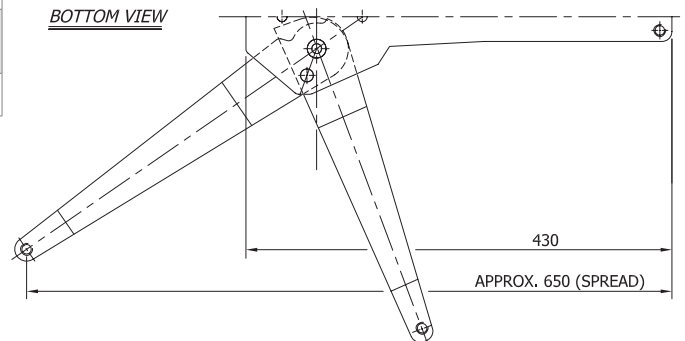

PORTABLE MONITOR

MODEL: NF-21A

DESCRIPTION

Portable Monitor is used in the place where operator is difficult to access like hazardous storage, outdoor oil tank, gas storage tank, chemical factory. Also equipped in the fire truck to deploy during fire fighting operation at the hard to access area. Monitor is light weight for easy transportation to required area. Foldable type legs can be folded by one simple touch for quick transportation.

Vertical movement is 90° (85° above and 5° below horizontal) and horizontal movement is a full, continuous 360° (hand wheel remains stationary), grease-zerk for easy lubrication.

APPLICATION

For total flooding applications, on the outdoor hydrant, fire trucks, mines, tunnels and etc.

TECHNICAL DATA

Inlet	2½" NH female swivel
Outlet	2½" NH male
Material	Aluminum alloy (ASTM 355)
Monitor Elevation	135° vertical movement Vertical movement controlled by Handwheel
Monitor Rotation	Horizontal movement 360° with positive twist locking mechanism
Net weight	20 kg approx.



Tip Size	Flow Rate @ 7 bar
20 mm	690 LPM
23 mm	900 LPM
26 mm	1130 LPM
29 mm	1400 LPM
32 mm	1770 LPM
38 mm	2490 LPM
48 mm	4000 LPM

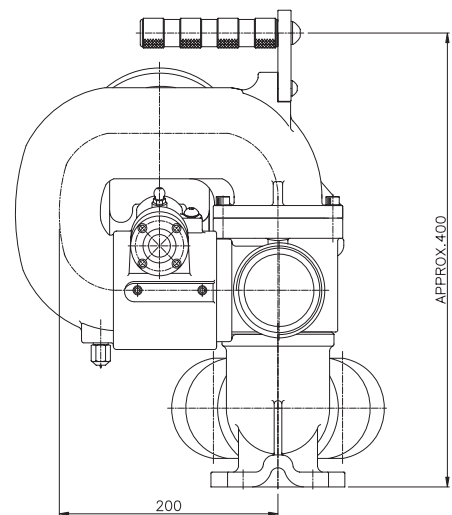
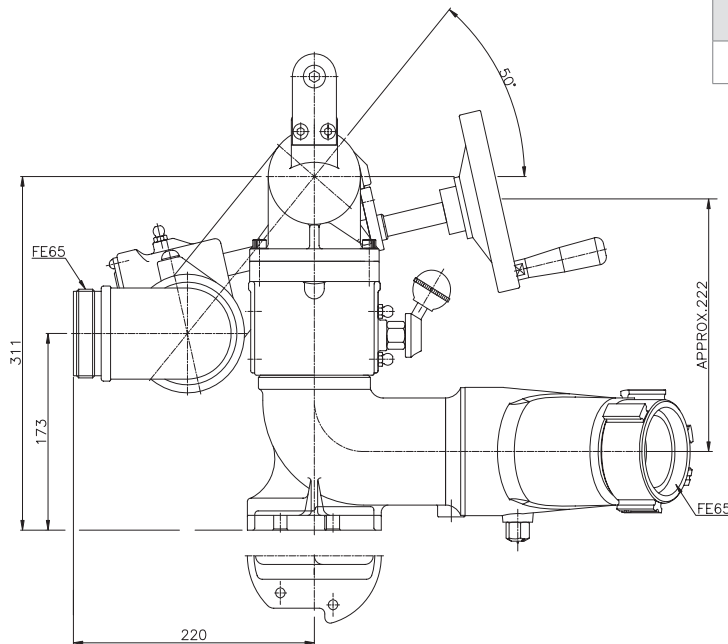

MONITOR

MODEL: NF-23A

DESCRIPTION

It is designed to apply placing on outdoor hydrant, fire truck and etc. Constructed of cast bronze or cast iron body. 2½" double water way with cast-in vane assures ease of operation. Vertical movement is 120° (80° above and 40° below horizontal) and horizontal movement is a full continuous 360°, grease fittings at all swivel joints for easy lubrication.

FEATURES

- Lever operation
- 2" inside diameter double waterway

APPLICATION

For total flooding applications, on the outdoor hydrant, fire trucks, mines, tunnels and etc.

TECHNICAL DATA

Inlet	3" or 4" Flanged ANSI#150
Outlet	2½" NH male
Material	Cast Iron or Cast Bronze (ASTM C83600)
Monitor Elevation	140° vertical movement
Monitor Rotation	Horizontal movement 360°
Net weight	25 kg approx. (Bronze)

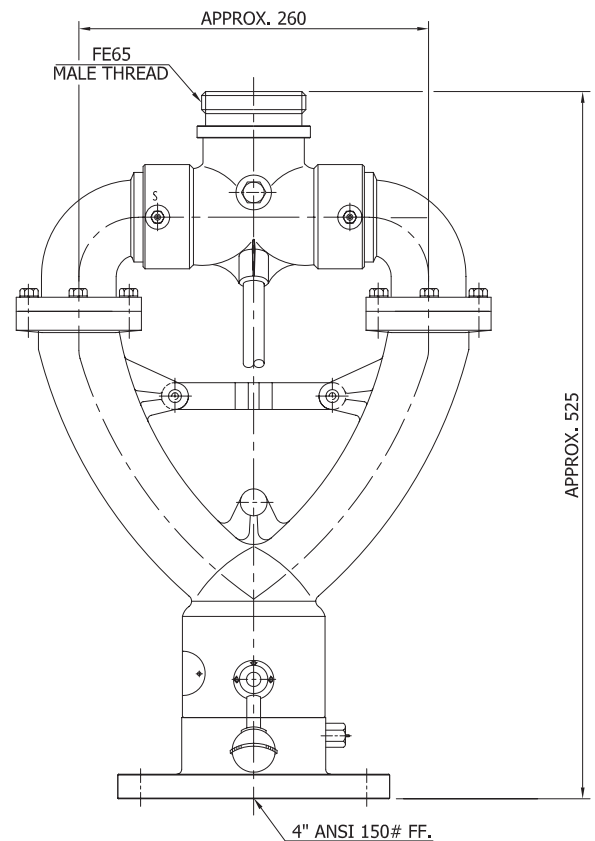
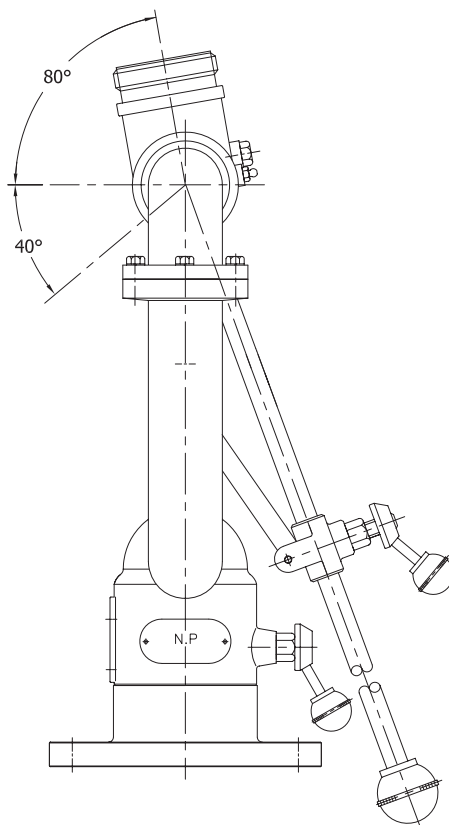

MONITOR

MODEL: NF-25A

DESCRIPTION

It is designed to apply placing on outdoor hydrant, fire truck and etc. Constructed of Aluminum fully enclosed gear cases for protection from the elements. 2" dual water way.

One lever assures ease of operation vertical movement is 135° (90° above and 45° below horizontal) and horizontal movement is a full continuous 360 (hand wheel remains stationary), and can stop any position with the positive twist locking mechanism.

FEATURES

- Lever controls both of horizontal and vertical positive twist locking system
- Fully covered dual-gears manual operation for protection from the elements
- 2" inside diameter dual waterway

APPLICATION

For total flooding applications, on the outdoor hydrant, fire trucks, etc.

TECHNICAL DATA

Inlet	2½" NH Female
Outlet	2½" NH male
Material	Aluminum alloy (ASTM 355)
Monitor Elevation	135° vertical movement
Monitor Rotation	Horizontal movement 360°
Net weight	27 kg approx.

